

THE THEATRE.

THE QUESTION OF THEATRES IS LUCKILY A POINT IN THE PROGRAMME THAT IS NEVER MENTIONED BUT IS INCLUDED IN EVERY BUILDING PROJECT. NOW IT HAS BEEN MENTIONED, I WANT TO DISOWN IT AND PUT IT BACK UNDER THE HEADING 'UNDESCRIBABLE'.

MAIN POINT: WHAT IS IT IF NO PERFORMANCE IS BEING GIVEN? THE 'THEATRE' CAN BE PLAYED IN EVERY DAY, IT IS AN EXTRA LARGE LANDING AND CAN BE USED FOR EVERYDAY TRAFFIC.

IN THIS INHABITED THEATRE THE 'ACTING' MUST BE ABLE TO BE PRACTISED EVERY DAY IN MANY PLACES IN DIFFERENT SITUATIONS. THEREFORE, NOT A CENTRAL THEATRE, AS MIGHT BE EXPECTED, BUT ONE NORMAL THEATRE AND THREE TIMES AN IMAGINARY THEATRE AND, BESIDES THAT, STILL MANY MORE PLACES IN WHICH, BY JUST BEHAVING NORMALLY, YOU SEEM TO BE ACTING.

THE THEATRE IS THE LINK BETWEEN DUTIES, THE SOURCE OF INCOME, FOLKLORE FROM HOME-SICKNESS, THE THEATRE IS LIVED IN.

THE AUDIENCE.

WHO IS THE AUDIENCE? CAN CHILDREN FORM AN AUDIENCE?

CHILDREN OF NINE NATIONALITIES, WHO ARE STILL INSTRUCTED IN THEIR NATIONAL CUSTOMS (WHICH IS OUT OF DATE), WOULD BE BETTER ABLE TO DEMONSTRATE THEIR FOLKLORE ABROAD THAN IN THEIR OWN LAND. PRESENT INTEREST IN NATIONAL CUSTOMS (AND INTEREST IN RACE IN GENERAL) PRESUPPOSES AN AUDIENCE BROUGHT IN FROM OUTSIDE, FROM EVERY CORNER OF OUR LAND, IT IS PUT OVER IN A THEATRE, LIVED-IN AND GIVEN MUCH PRACTICE, IN WHICH MANY PERFORMANCE IN MANY PLACES ARE TAKING PLACE AT THE SAME TIME.

FOR THIS REASON THE PROGRAMMES PRESENTED IN THE HEART OF THE PROJECT ARE TO BE REGARDED AS 'OUTDOOR PERFORMANCES'.

THE VILLAGE HALL MUST BE MORE LIKE AN OPEN SQUARE THAN A BUILDING, AND, INVERSELY, THE VILLAGE SQUARE MUST BE LESS A SQUARE THAN A BUILDING. (A SQUARE AS A STATION.)

THE PROGRAMME.

ABOUT TEN NATIONALITIES CONSISTING OF MIN. 24 AND MAX. 28 FAMILIES (OF SIXTEEN CHILDREN), THIS IS INTERPRETED AS FOLLOWS: THE JURY REALIZES THE PLASTIC SEQUENCES OF NUMBERS;

IF '10 AND 24' WAS THE REQUIREMENT THE SIZE OF A NATIONALITY MUST BE VARIABLE; CONNECTION BETWEEN ACCIDENTAL SIZE OF NUMBERS AND NATIONAL CHARACTERISTICS (RELATING TO SIZE) NEVER OCCUR LOGICALLY (A CHANGING REALITY WHICH CAN NEVER BE PREDICTED!).

CONCLUSION.

THESE LITERAL FIGURES GIVE TOO WEAK A GROUND FOR VARIATION (BETTER GROUND ON CONSULTATION WITH AUTHORITY GIVING COMMISSION). DIFFERENCES IN SIZE BETWEEN NATIONALITIES CONSISTING OF 2, 3 OR 4 FAMILIES ARE VERY LARGE (50%).

SINCE THE CARE WILL BE GIVEN ALMOST ENTIRELY PER NATIONALITY, (REASON-CONNECTION BETWEEN CARE AND NATIONAL 'CUSTOM') ONE NATIONALITY MAY CERTAINLY BE NEITHER TOO LARGE NOR TOO SMALL.

WHERE 9 NATIONALITIES CONSIST OF 27 FAMILIES (28, 24) ONE NATIONALITY CONSIST OF 3 FAMILIES. THE NUMBER 3 IS NOW UNDERSTOOD AS THE 3 CORNERS OF A SQUARE. THE FOURTH CORNER FORMS A 'BRIDGE' IN THE MULTIPLICATION WITH THE SERVANT FACILITIES PROGRAMME. IN THIS WAY THE ENLARGEMENTS (MULTIPLICATION) AS WELL THE REDUCTIONS (SPLITTING-UP INTO DETAILS) ARE COMPLETED.

SEE THE SCHEMES; THE MAIN HEADINGS ARE:

1. THE DORMITORY HOUSE,
2. THE FAMILY HOME,
3. A NATIONALITY,
4. PER THREE, THE SETTLEMENT OF A NATIONALITY,
5. THE TOTAL AREA AS OPPOSED TO THE OUTER WORLD.

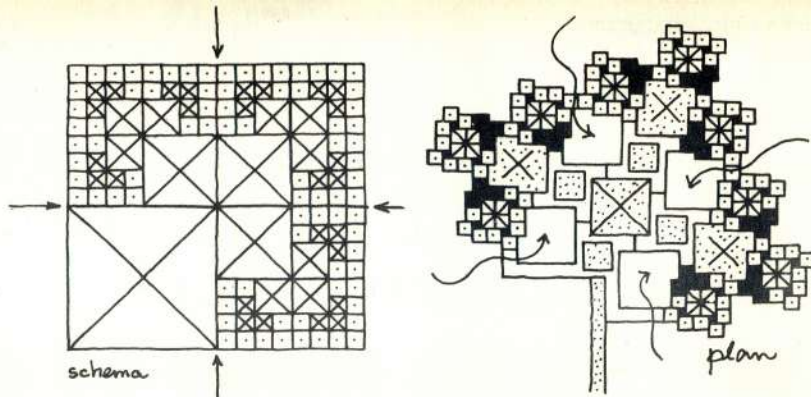

MAISON DE FAMILLE + 1/4 CENTRE NATIONAL DE LA MAISON



PROGRAMME DU "PONT" = MAISON DES SOINS POUR UNE NATIONALITE + 1/4 CENTRE NATIONAL DE LA MAISON



PROGRAMME DU "PONT" = VERS LE VILLAGE (LA MAISON DE VILLAGE) PAR 3 NATIONALITES = ELEVATION DES NATIONALITES EGALE A 1/4 PAR MAISON DE VILLAGE



LA PENETRATION DE LA NATURE SOUS LA FORME DE L'EAU

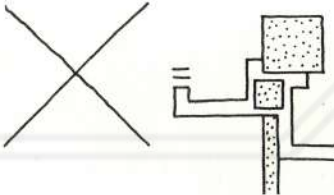

"PONT" POUR LA SOCIETE VILLAGE DE METIERS; AUBERGE, BELVEDERE, SERVICES, SOINS.

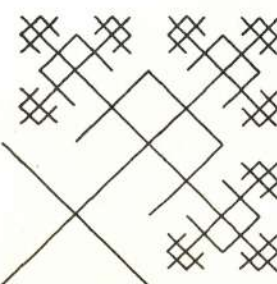

brug als geheel = verzagingsorganisme.

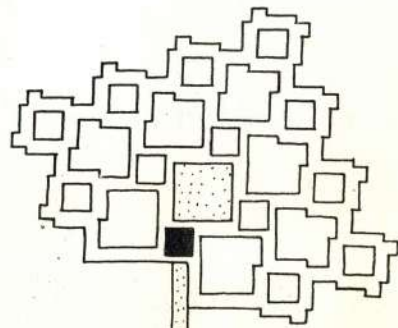

resultaat: opheffing verzagend accent.

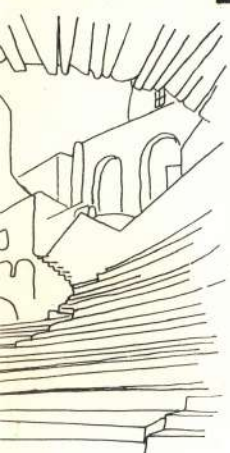

functies, bron van inkom-
water is besword.

TOEHOORDERS:

wie is het gehoor? kunnen kinderen toekomen dan zijn? uit 9 nationaliteiten kinderen welke nog in hun volksoverleving onderhouden (en dat is uit de tijd) zullen hun volklore in de vorm van beten kennen niet dat het dan in eigen land de bekende belangstelling van volksoverleving (de belangstelling van ras in het algemeen) is ondersteld gehoor van buiten de stad uit alle rindsteden van ons land, het komt over de brug' in een besword en goeford theater van een op vele plekken vele volksoverleving; het is plaats van den ondiepe zijn de programma's van het hart van het plan vestaan als om het plan programma's het ontwerp moet meer een plan zijn dan een gebouwen omgekeerd met het ontwerp plan minder plan dan gebouwen zijn (aan plan als een station)

